

UNIT: mm (毫米)

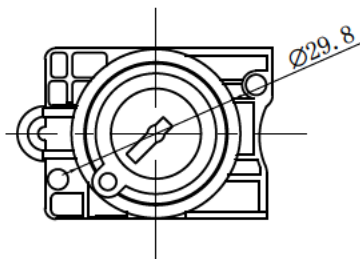

开关结构说明:  
Switch structure description:

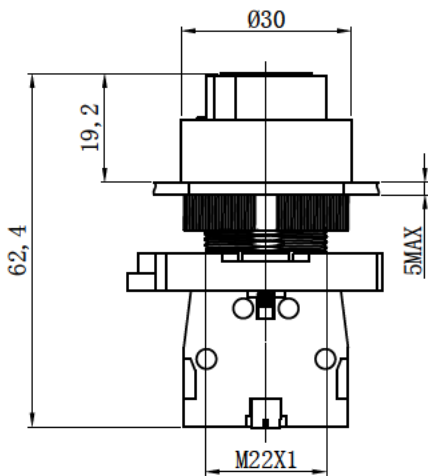
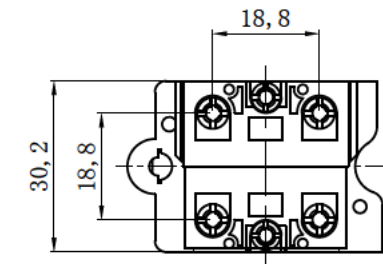
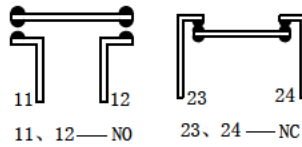

安装孔尺寸:  
Mounting hole size:

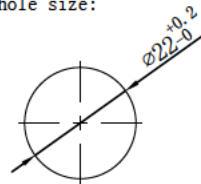

性能要求:

Performance requirements:

1. 接触电阻:  $\leq 50m\Omega$ ;  
Contact resistance:  $\leq 50m\Omega$ .
2. 绝缘电阻:  $\geq 100M\Omega$ ;  
The insulation resistance:  $\geq 100M\Omega$ .
3. 抗电强度: AC2500V, 1min, 无闪烁、击穿;  
Electrical resistance: AC2500V, 1min, no flicker and breakdown;
4. 寿命: 电气部分在额定负载下动作5万次无异常。  
Life: Electrical part: operate 50,000 times. under rated load without any abnormality.  
机械部分: 动作100万次无异常;  
Mechanical part: no abnormal movement for 1000,000times.

技术要求:

Technical requirements:

1. 表面光洁, 平整无毛刺;  
The surface is smooth without burr;
2. 参数/批次字迹清晰, 无错位;  
Clear handwriting of parameters/batches without any dislocation;
3. 电气参数: Ith: 10A Ui: 400V;  
Electric parameter: 10A Ui: 400V;
4. 工作环境温度:  $-25^{\circ}\text{C} \sim +65^{\circ}\text{C}$ ;  
Working environment temperature:  $-25^{\circ}\text{C} \sim +65^{\circ}\text{C}$ ;
5. 动作形式: 自锁式;  
Operation type: Latching;
6. 动作行程: 两档 $90^{\circ}$ ;  
Movement stroke: Two  $90^{\circ}$ ;
7. 连接形式: 导线;  
Connection form: wire;
8. 拧紧力矩: 约0.6Nm;  
Tightening torque: about 0.6Nm;
9. 开关组合: 1NO1NC;  
Contact configuration: 1NO1NC;
10. 未标注公差按照GB/T 1804-m级。  
Unmarked tolerance shall be in accordance with GB/T 1804-m class.

描 图

描 校

底 图 号

装 订 号

标 记		处 数	更改文件号	签 字	日 期	名称(TITLE): M2 Metal button switch M22金属按钮开关
DR	APPD.	SCALE	countersign	Date		
制 图	审 核	比 例	会 签	日 期		图号(DWG NO): HBV5E-11Y-21
PW		P. 页 码	第1页 共1页 (1/1)			