

ISS.	AMEND	DATE
1	ISSUED	19/12/14

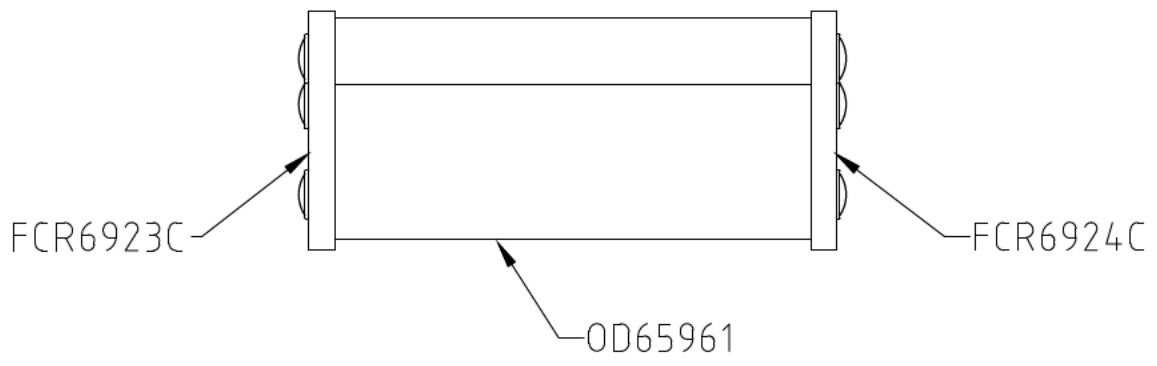
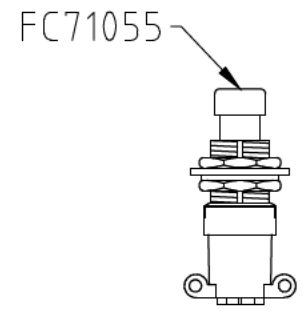
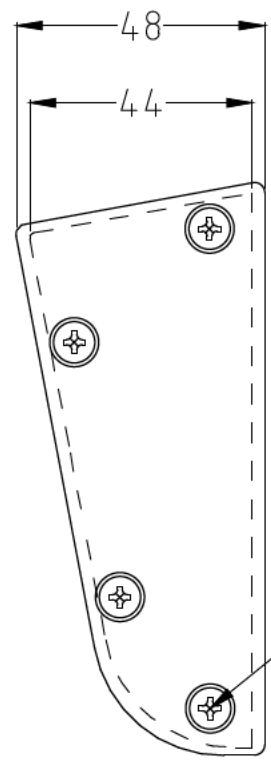
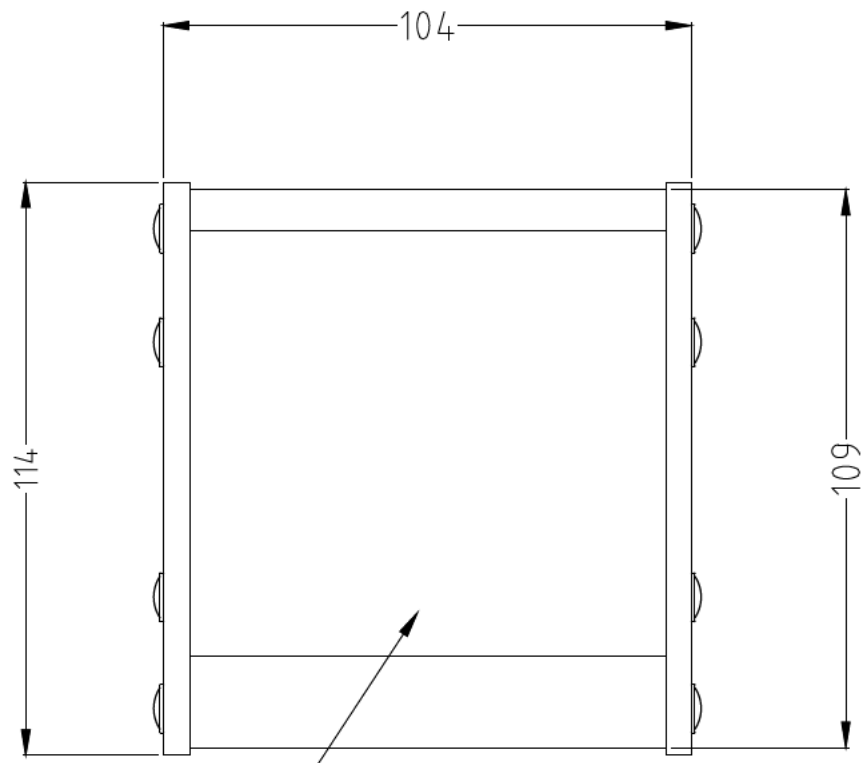

KIT INCLUDES

- 100mm ALI EXTRUSION
- 100mm BASE PLATE
- 1x RH END
- 1x LH END
- 8x SCREWS
- 1x DPDT ON/OFF SWITCH

SUPPLIED ASSEMBLED + SWITCH

RoHS COMPLIANT
TOLERANCE
NO DEC. PLACE ±
1 DEC. PLACE ±
2 DEC. PLACE ±
HOLE Ø ±
ANGLES ±
UNLESS OTHERWISE STATED
DO NOT SCALE

		3rd ANGLE PROJECTION:	
MATERIAL: ALI / POLYAMIDE / PVC / STEEL		TITLE: ON/OFF FOOT PEDAL (100mm)	
FINISH: CLEAN		DRWG. No. CL2107C	
DRAWN:		APPROVED:	
THE CONTENTS OF THIS DOCUMENT MUST NOT BE COPIED OR DISCLOSED TO A 3rd PARTY WITHOUT WRITTEN PERMISSION OF CLIFF UK. © 2013		FORM: A4DRWGH	

SWITCHES

4066 SERIES



- FC71025** SPDT ON/OFF solder tags.
- FC71035** SPDT ON/OFF PC tags
- FC7105** DPDT Momentary solder tags.
- FC71055** DPDT ON/OFF solder tags.
- FC7106** DPDT Momentary PC tags
- FC71065** DPDT ON/OFF PC tags

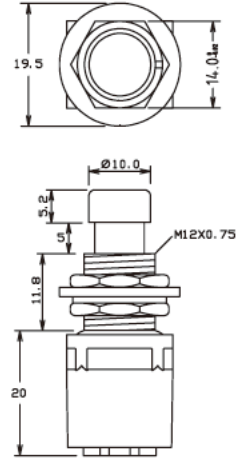

Rated 1A. 250VAC

Contact Sales for full drawing and specification.

3 POLE SERIES



FC71101

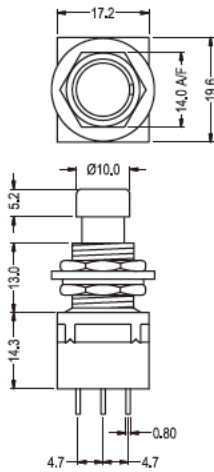

3PDT switch solder tags

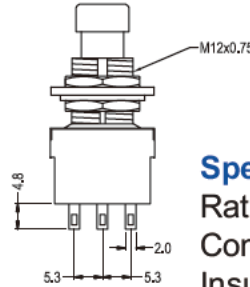

Specification

- Rating: AC125V 4A, 250V 2A.
- Contact Resistance: 20mΩ max.
- Insulation Resistance: DC500V 100MΩ min.
- Dielectric Strength: AC1500V 1 minute.
- Operating temp: -20°C to +65°C
- Electrical life: 20,000 make/break cycles at full load.



FC71102

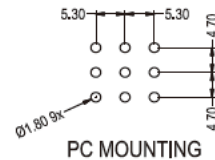
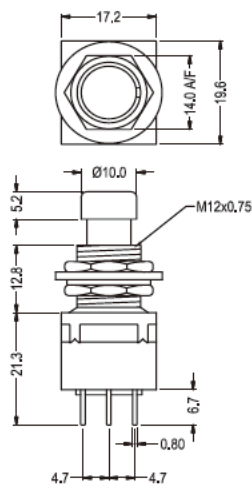

PC MOUNTING

3PDT switch PCB tags.

