

# IB series

Snap-in sealed pushbutton switches •  
bushing Ø 12 mm • momentary



## DISTINCTIVE FEATURES

- Snap-in models
- Compact, lightweight
- Tactile feedback
- Sealed to IP54



## ENVIRONMENTAL SPECIFICATIONS

- Front panel sealing according to IEC 60529 : IP54
- Shock resistance : 100 g according to IEC 512-4, test 6c
- Vibration resistance : 10-500 Hz - 10 g according to IEC 512-4, test 6d
- Salt spray : IEC 512-6, test 11f
- Operating temperature : -40 °C to +85 °C (-40 °F to +185 °F)



## ELECTRICAL SPECIFICATIONS

- Max. current/voltage rating with resistive load :  
400 mA 32 VAC - 100 mA 48 VDC
- Initial contact resistance : 50 mΩ max.
- Insulation resistance : 1 GΩ min. at 500 VDC
- Dielectric strength : 1,000 Vrms
- Electrical life at full load : 500,000 cycles



## GENERAL SPECIFICATIONS

- Panel thickness : 0.8 mm (.031) min. - 1.8 mm (.071) max.
- Total travel : 1.7 mm (.066) ± 0.3 mm
- Typical operating force : 4 N ± 3 N
- Low level or mechanical life : 1,000,000 cycles
- Soldering : 300 °C (572 °F) max. for 3 seconds

The company reserves the right to change specifications without notice.



# IB series

Snap-in sealed pushbutton switches •  
bushing Ø 12 mm • momentary



## MATERIALS

- Case : thermoplastic UL94-V0
- Actuator : polyamide 6/6
- Bushing/bezel : polyamide 6/6
- Contacts : silver, gold plated
- Terminal seal : epoxy

## AGENCY APPROVAL



2 A 125 VAC/250 VAC  
File E83438

Availability : consult factory for details of approved models.

Marking : to order switches marked UL, complete appropriate box of ordering format.



## TERMINALS

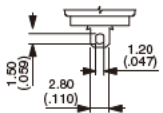

Solder lug S

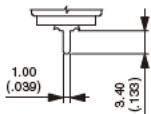

Straight P

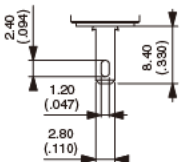

Quick-connect Z



## ELECTRICAL FUNCTIONS

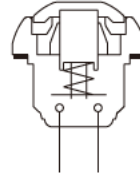

Function 3 (NO)



## MOUNTING STANDARD BEZEL

### PANEL CUT-OUT

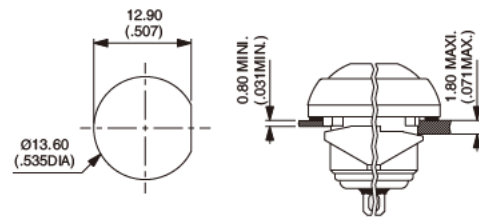

### MATRIX MOUNTING

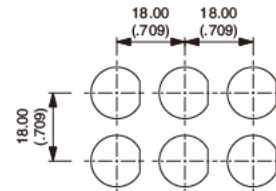

## MOUNTING REDUCED MODEL

### PANEL CUT-OUT

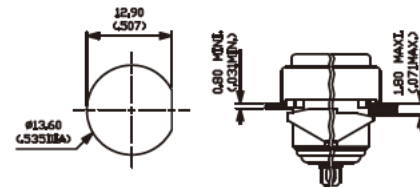

### MATRIX MOUNTING

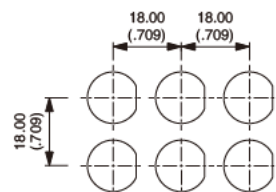

# IB series

Snap-in sealed pushbutton switches •  
bushing Ø 12 mm • momentary



## BUILD YOUR PART NUMBER

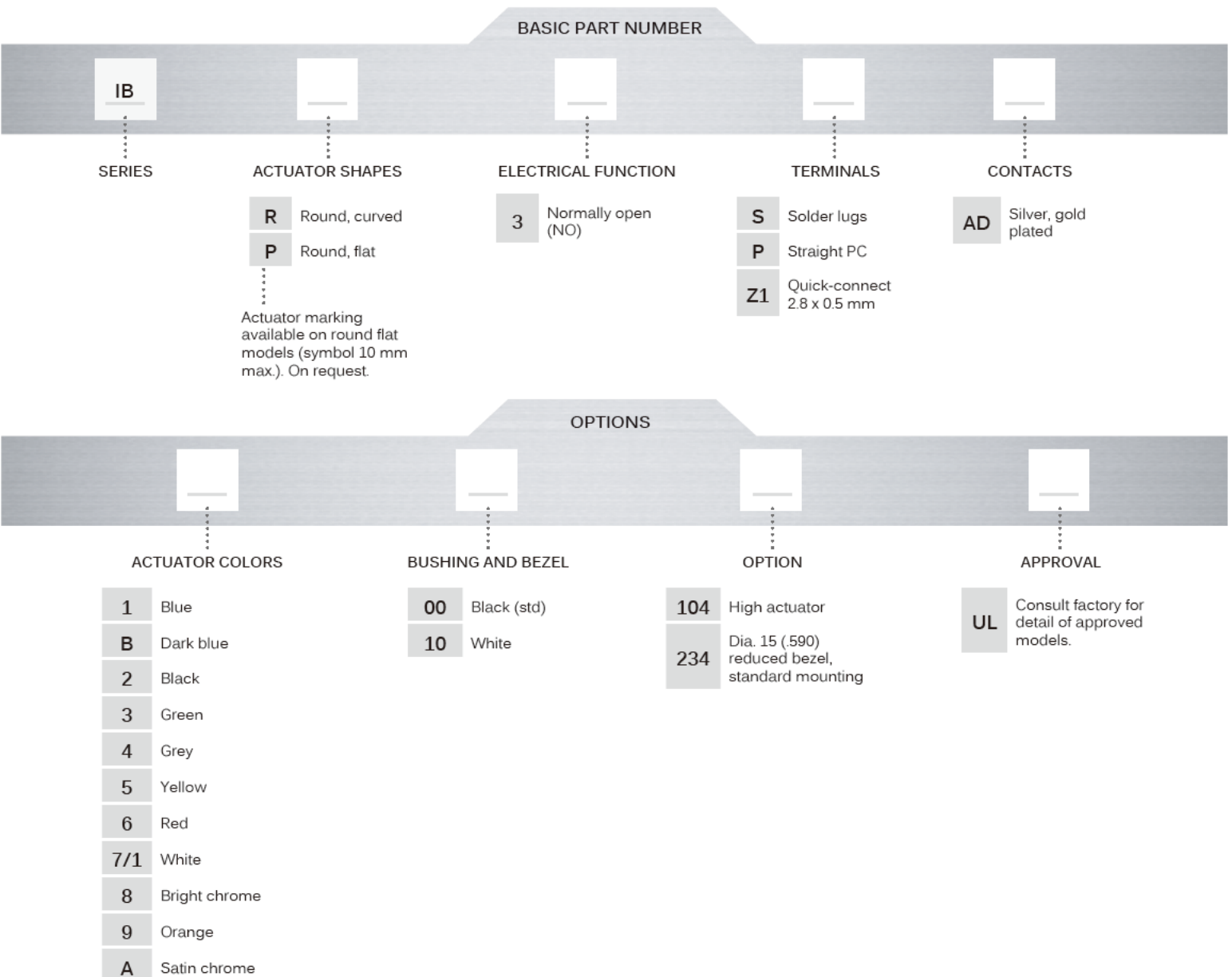

## ABOUT THIS SERIES

On the following pages, you will find successively basic part numbers of switches and options in the same order as in above chart.



- Notice** : please note that not all combinations of above numbers are available. Refer to the following pages for further information.
- A sealing boot** is available to protect the switches against frost and sand (P/N U5125). See "Sealing Boots" section of website.
- Mounting accessories** : Standard hardware supplied : 1 flat seal.

# IB series

Snap-in sealed pushbutton switches •  
bushing Ø 12 mm • momentary

## SOLDER LUG TERMINALS



- Curved actuator  
**IBR3SAD**  Normally Open
- Flat actuator  
**IBP3SAD**  Normally Open

→ FLAT

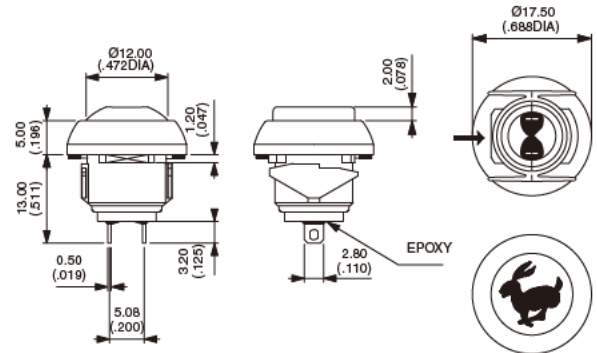

Also available with straight PC : **IB•3PAD** or quick-connect terminals : **IB•3Z1AD**

### ACTUATOR COLORS

BASIC P/N

- |     |               |
|-----|---------------|
| 1   | Blue          |
| B   | Dark blue     |
| 2   | Black         |
| 3   | Green         |
| 4   | Grey          |
| 5   | Yellow        |
| 6   | Red           |
| 7/1 | White         |
| 8   | Bright chrome |
| 9   | Orange        |
| A   | Satin chrome  |

### BUSHING AND BEZEL

BASIC P/N

- |    |                  |
|----|------------------|
| 00 | Black (standard) |
| 10 | White            |

# IB series

Snap-in sealed pushbutton switches •  
bushing  $\varnothing$  12 mm • momentary

## OPTIONS



- 104 High actuator
- 234 Dia. 15 (.590) reduced bezel, standard mounting

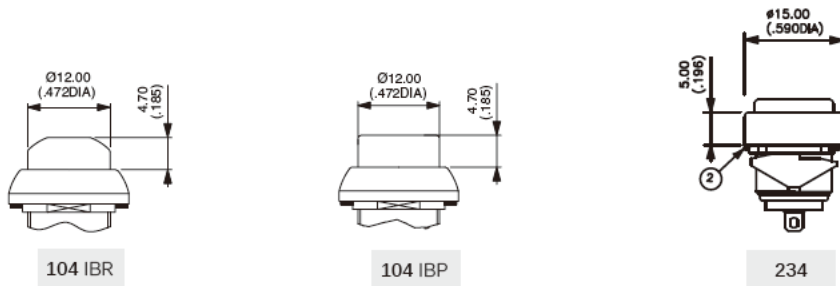

## AGENCY APPROVAL



- UL**  
**Availability :** consult factory for details of approved models.  
**Marking :** to order switches marked UL, complete appropriate box of ordering format.