

KL series

Locking power rocker switches



DISTINCTIVE FEATURES

- One protected position
- Patented intuitive ergonomics
- Laser etched symbols
- Illuminated or non-illuminated
- Optionally sealed to IP69K



ENVIRONMENTAL SPECIFICATIONS

- Sealing options :
 - K : IP68 to front panel components of switch only according to IEC 60529
 - Z : IP69K panel sealing according to DIN 40050-9
- Salt spray resistance : 96 hours according to IEC 512-6, test 11f
- Operating temperature : -40 °C to +85 °C (-40 °F to +185 °F)



ELECTRICAL SPECIFICATIONS

- Current/voltage rating with resistive load :
 - Silver plated contacts :
 - A : 5 A 24 VDC, 100,000 cycles
 - 10 A 24 VDC, 10,000 cycles (terminals 6.35 x 0.8 only)
 - S : 20 A 12 V, 10,000 cycles (see "Build your part number")
 - Gold plated contacts (D) : 20 mA 12 V, 150,000 cycles
- Initial contact resistance : 10 mΩ max.
- Insulation resistance : 1,000 MΩ min. at 500 VDC
- Dielectric strength : 2,000 Vrms 50 Hz min. between terminals
- Mechanical life : 150,000 cycles min.



GENERAL SPECIFICATIONS

- Mechanical life : 150,000 cycles min.
- Panel thickness : 0.8 mm to 4.6 mm
- Recommended panel thickness : between 2 mm and 3.5 mm

The company reserves the right to change specifications without notice.



KL series

Locking power rocker switches

MATERIALS

- Case : PA 6-6
- Actuator : ABS
- Unlocking actuator : ABS or elastomeric membrane
- Bezel : PA 6-6
- Contacts & terminals : brass, solid silver grain, silver plated (A or S) or brass, solid silver grain, gold plated (D)
- Contact roller : brass, nickel plated

SEALING

- Sealing is optional. To order a sealed product, complete the appropriate box of ordering format on the following pages.

MATRIX MOUNTING

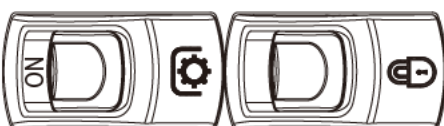
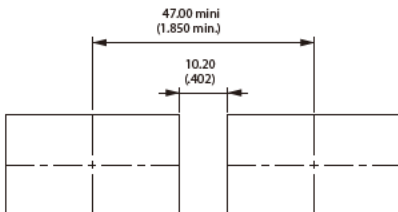
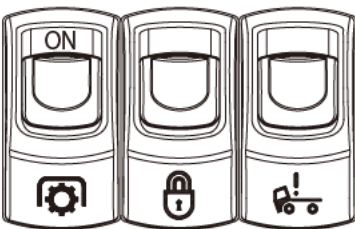
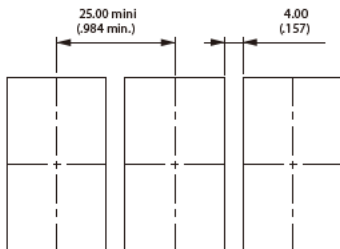

PANEL CUT-OUT

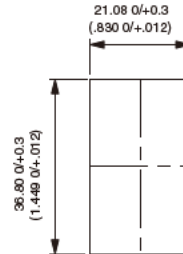

SPECIFIC MATRIX MOUNTING FOR Z VERSION

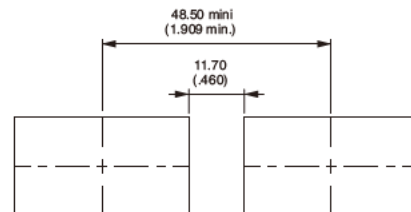
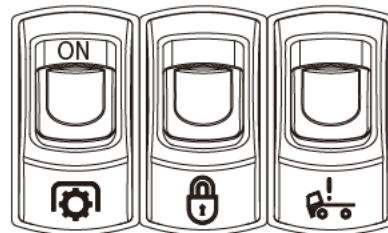
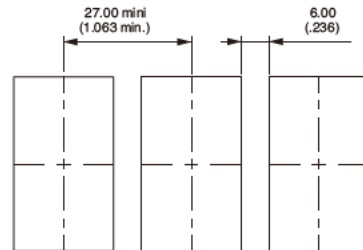

KL series

Locking power rocker switches



ELECTRICAL FUNCTIONS AND CONNECTIONS

In the tables below, terminal connections as viewed from bottom of switch. Only the contact area is represented. For single pole models, only terminals 1, 2 and 3 are to be considered (not 6, 5, 4).

x = w/o terminal
o = with terminal
▲ = momentary

2 POSITIONS

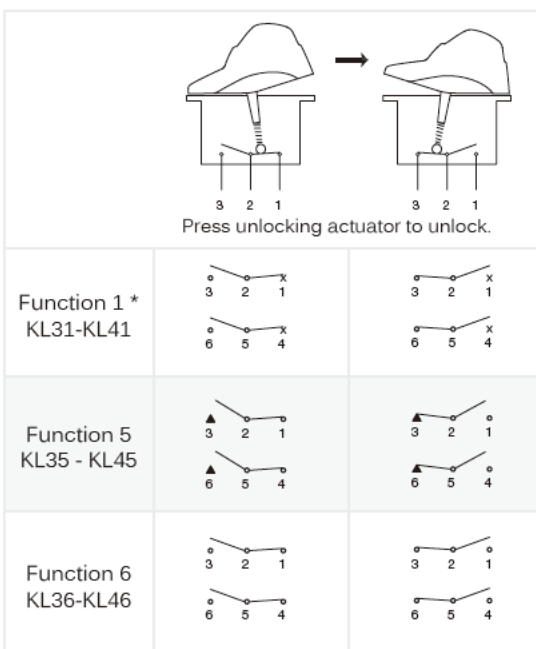

* Function 1 : Only available for 6 terminal versions, illuminated versions only available with "A" wiring.

3 POSITIONS

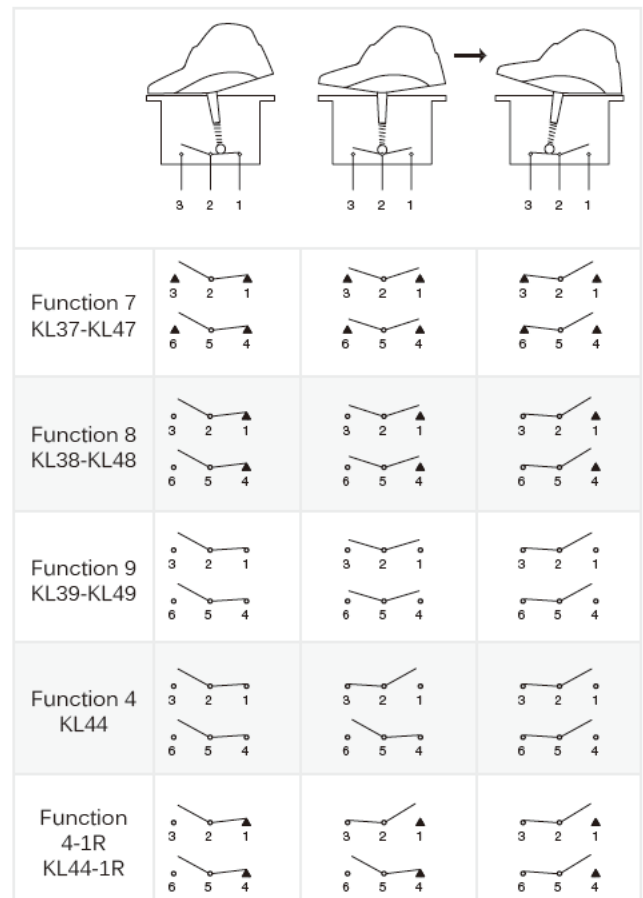

TERMINALS

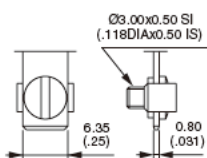

Screw

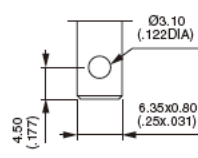

Solder lug / quick-connect

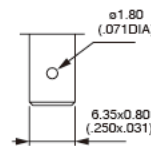

Normalized quick-connect 6.35x0.8

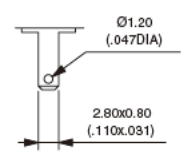

Normalized quick-connect 2.8x0.8

KL series

Locking power rocker switches



BUILD YOUR PART NUMBER

To order a complete product, fill in all the boxes of the following order guide.

CASE + LEADS

KL							Side B				
SERIES	POLES	ELECTRICAL FUNCTIONS			CONTACTS	SEALING	LEADS	WIRING			
3 Single pole	4 Double pole	1	ON	-	OFF	A	Silver	X	No	F	LED 12 V yellow
		4	ON	ON	ON	D	Gold plated	K	IP68	N	LED 12 V blue
		4-1R	ON	ON	MOM	S	Silver 20 A***	Z	IP69K	S	LED 12 V white
		5	MOM	-	ON			A	LED 6 V red	J	LED 24 V red
		6	ON	-	ON			B	LED 6 V green	K	LED 24 V green
		7	MOM	OFF	MOM			C	LED 6 V yellow	L	LED 24 V yellow
		8	ON	OFF	MOM			M	LED 6 V blue	P	LED 24 V blue
		9	ON	OFF	ON			R	LED 6 V white	T	LED 24 V white
								D	LED 12 V red		
								E	LED 12 V green		

Function 1 only for 6-terminal versions. Functions 5 and 6 cannot be combined with "H" wiring.

TERMINALS

Screw	Solder lug/quick-connect	Normalized quick-connect 6.35x0.8	Normalized quick-connect 2.8x0.8
0	6 terminals with barrier	2	6 terminals with barrier
		3	6 terminals w th barrier
		4	6 terminals w/o barrier
		5	6 terminals w/o barrier
		D	10 term. with barrier
		E	10 term. w/o barrier
		F	10 term. for use with connector U2292 or U3152
		G	10 term. with barrier
		H	10 term. w/o barrier
		J	10 terminals for use with connector U2282

*** S contacts for all functions except 5 and 4-1R - for normalized quick-connect terminals 6.35x0.8 only.

ACTUATOR

TYPE	UNLOCKING ACTUATOR COLOR		SYMBOLS	MARKING COLOR
1				Illuminated models
2				Non-illuminated
				Blank
				1
				2
				3
				4
				5
				6
				7
				8
				9

MARKING ORIENTATION

ROCKER COLOR		
1	Blue	3
1/4	Dark blue	4
2	Black	5
3	Green	6
4	Grey	7
5	Yellow	8
6	Red	9
7	Ivory	
8	Orange	

Symbols & Accessories : see end of the series.

NOTICE : please note that not all combinations of above numbers are available. Refer to following pages for further information.

KL series

Locking power rocker switches

6 TERMINAL VERSION



	Single pole	Double pole	2-3 5-6	1-2 4-5
KL31	KL41	ON	-	OFF
	KL44*	ON	ON	ON
	KL44-1R*	ON	ON	MOM
	KL45	MOM	-	ON
KL36	KL46	ON	-	ON
KL37	KL47	MOM	OFF	MOM
KL38	KL48	ON	OFF	MOM
KL39	KL49	ON	OFF	ON

*Function 4 and 5 : single pole in double pole case

10 TERMINAL VERSION



	Single pole	Double pole	2-3 5-6	1-2 4-5
KL31	KL41	ON	-	OFF
	KL44*	ON	ON	ON
	KL44-1R*	ON	ON	MOM
	KL45	MOM	-	ON
KL35	KL46	ON	-	ON
KL36	KL47	MOM	OFF	MOM
KL37	KL48	ON	OFF	MOM
KL38	KL49	ON	OFF	ON

*Function 4 : single pole in double pole case

→ FLAT SEAL
47.00
(1.850)

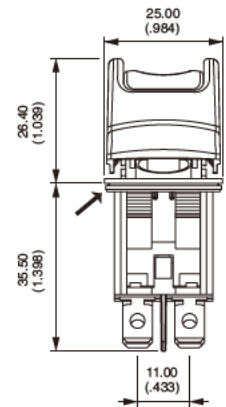
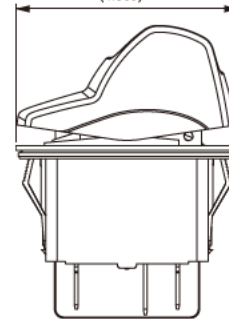

→ FLAT SEAL
47.00
(1.850)

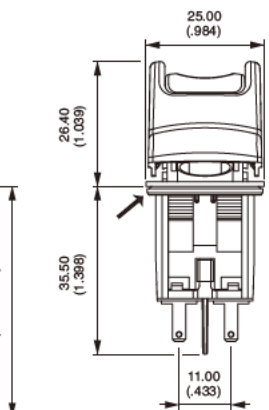
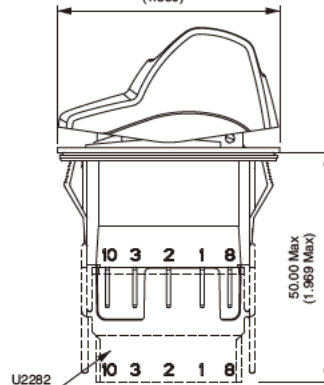

CASE + LEDS



SCREW

0 6 terminals with barrier

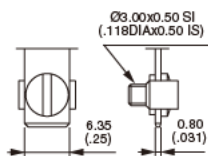

screw

SOLDER LUG / QUICK-CONNECT

- 2 6 terminals with barrier
- 4 6 terminals w/o barrier
- A 10 terminals with barrier
- B 10 terminals w/o barrier
- C 10 terminals for use with connector U2292 or U3152

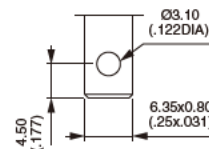

Solder lug / quick-connect

KL series

Locking power rocker switches

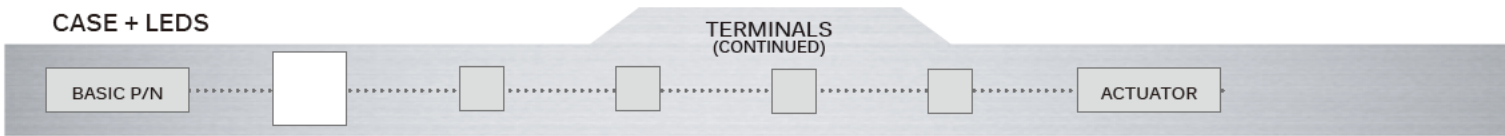

NORMALIZED QUICK-CONNECT 6.35X0.8

- 3 6 terminals with barrier
- 5 6 terminals w/o barrier
- D 10 terminals with barrier
- E 10 terminals w/o barrier
- F 10 terminals for use with connector U2292 or U3152

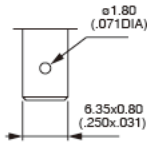

Normalized quick-connect 6.35x0.8

NORMALIZED QUICK-CONNECT 2.8X0.8

- G 10 terminals with barrier
- H 10 terminals w/o barrier
- J 10 terminals for use with connector U2282

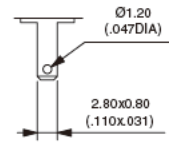

Normalized quick-connect 2.8x0.8

6 TERMINAL VERSION

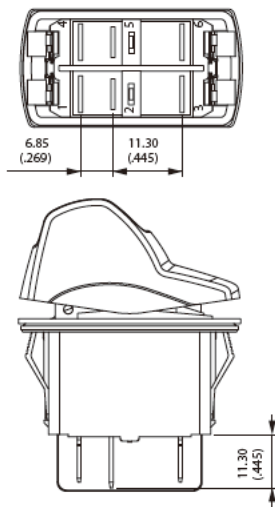

10 TERMINAL VERSION

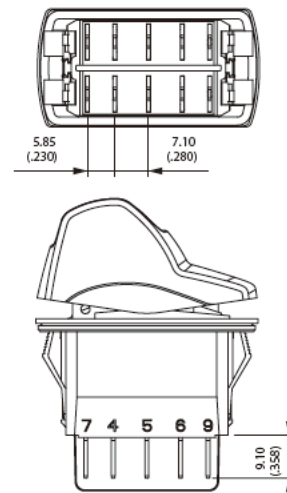

Terminals are marked on the case. The drawings show the maximum possible number of terminals.

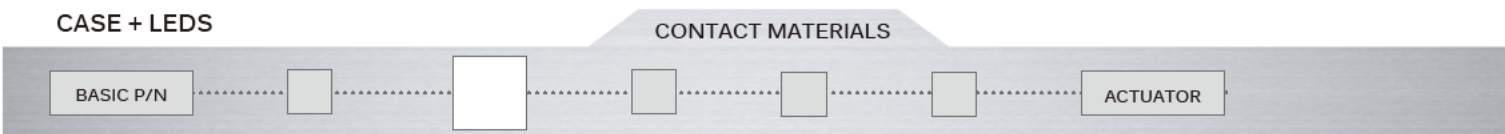

- A Silver
- D Silver, gold plated
- S Silver 20A. For all functions except 4 and 4-1R - for normalized quick-connect terminals 6.35x0.8 only.

KL series

Locking power rocker switches

CASE + LEADS

SEALING



- X No sealing
- K IP68 (front panel components of switch only)
- Z IP69K - Installation notice available on request

Ultrasonic welding of frame to case is standard on all versions. The ultrasonic welding and the optional panel seal prevent water and dust from introducing into the switch housing.

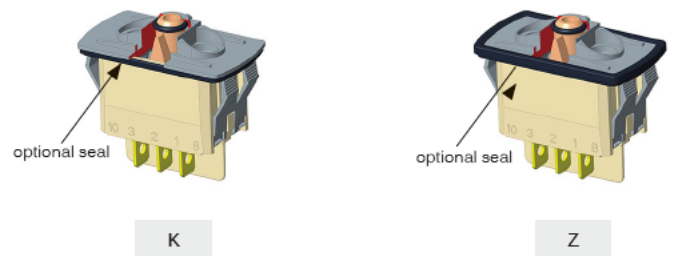

CASE + LEADS

LEDS



Complete enlarged box with one of the codes listed below.

- X Without LED

	Red	Green	Yellow	Blue	White	Amber	Red/green
6 VDC	A	B	C	M	R	4	1
12 VDC	D	E	F	N	S	5	2
24 VDC	J	K	L	P	T	6	3
No resistor	U	V	W	Y	Z	9	8

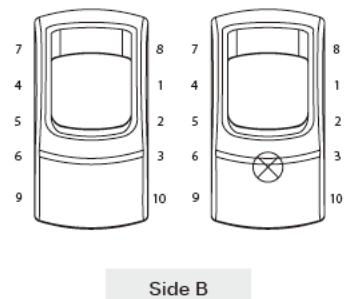

LED consumption : 20 mA @ nominal voltage (25 °C / 77 °F)
Other illumination solutions : on request.

For non-stabilized on-board power supplies submitted to potential voltage surges due to the alternator, 15 V and 30 V LED configurations are also available on request. LED Tolerance $\pm 10\%$

CASE + LEADS

WIRING



The LED wiring diagram is shown on the case.

FOR 6 TERMINAL VERSIONS - LED CONNECTED TO THE LOAD

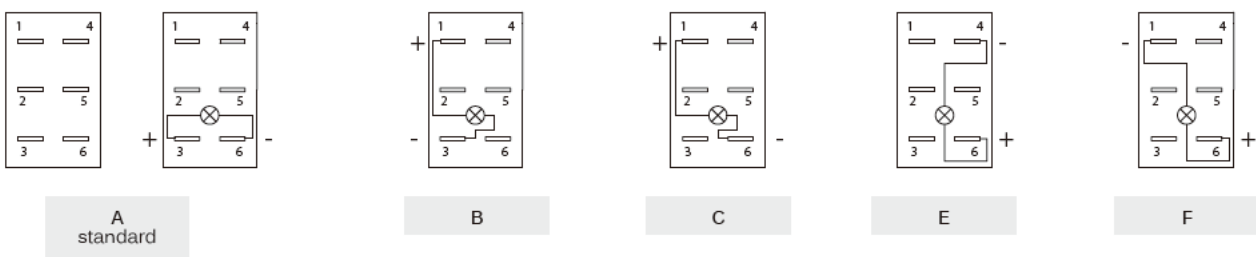

Note : If not available, terminals are added to connect the LED.

KL series

Locking power rocker switches

CASE + LEDS

WIRING (CONTINUED)

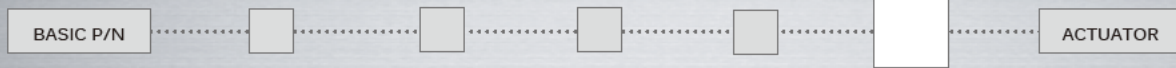

FOR 10 TERMINAL VERSIONS - INDEPENDENT LED OR INTEGRATED FUNCTIONS

- G** Standard, to have independent LED.
- H** To obtain 2 symbol illumination levels (night illumination when OFF and higher illumination when ON).
Dotted line = external wiring, continuous line = internal wiring
Available in Single Pole only, with H and J quick-connect terminals
- I** To have a polarity inversion (typical application : fan motor).
Dotted line = external wiring
Power supply between 2 and 5 - Load between 1 and 4 or 3 and 6.
Available with H and J quick-connect terminals.

Please contact us for other wiring solutions.

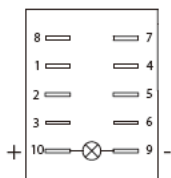

G

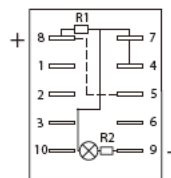

H

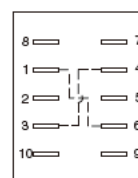

I

ACTUATOR

ACTUATOR TYPE



- 1 For non-illuminated application
- 2 For illuminated application

ACTUATOR

ROCKER COLOR



- 1 Blue
- 1/4 Dark blue
- 2 Black
- 3 Green
- 4 Grey
- 5 Yellow
- 6 Red
- 7 Ivory
- 9 Orange

Note : color 7 not available on illuminated versions

KL series

Locking power rocker switches

ACTUATOR

UNLOCKING ACTUATOR



HARD PLASTIC (ABS)

1	Blue	5	Yellow
1/4	Dark blue	6	Red
2	Black	7	Ivory
3	Green	9	Orange
4	Grey		

ELASTOMER

Y	Yellow
R	Red
G	Green
W	White

ACTUATOR

MARKING ORIENTATION



If no marking required, complete the box with code N.
Other orientations : on request

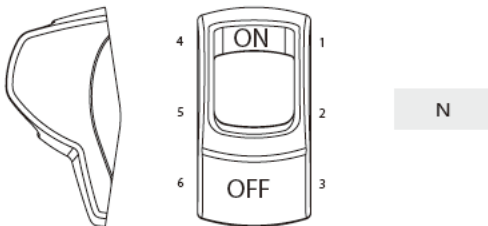

ACTUATOR

SYMBOLS

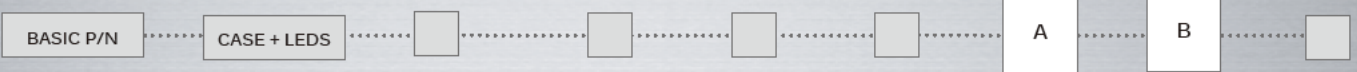

XX No symbol

If no marking required, end up the part number with Actuator marking orientation (see above)

Available symbols

Complete each enlarged box with the one of the codes listed on the following pages.

Laser etching resistance

- Water and petrol resistant according to EN61058-1
- Tear resistant (cross-cut test) according to NF ISO 2409 : class 0
- UV resistant according to ISO 4892-2

Marking area

The symbol will be included in the hatched area.

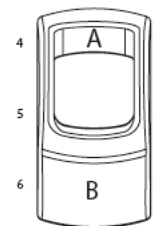

KL series

Locking power rocker switches

For illuminated versions

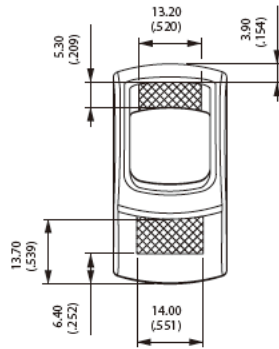

For non-illuminated versions

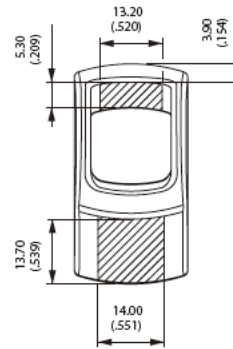

ACTUATOR

MARKING COLOR

BASIC P/N

CASE + LEDS

ILLUMINATED MODELS - LASER ETCHING

Blank White

NON-ILLUMINATED MODELS - PAD PRINTING

- 1 Blue
- 2 Black
- 3 Green
- 4 Grey
- 5 Yellow
- 6 Red
- 7 White
- 9 Orange