

NUT 2PCS

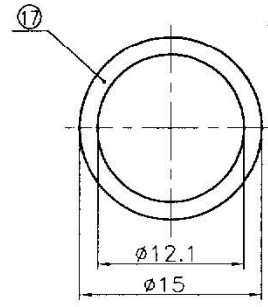

WASHER 1PCS

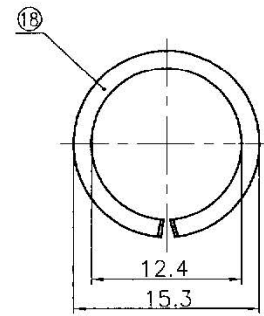
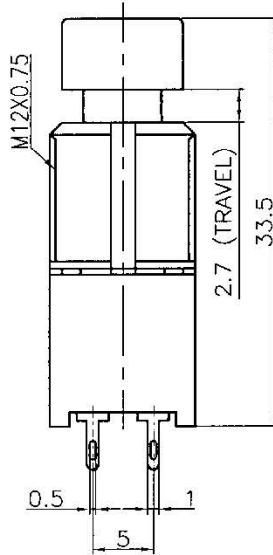
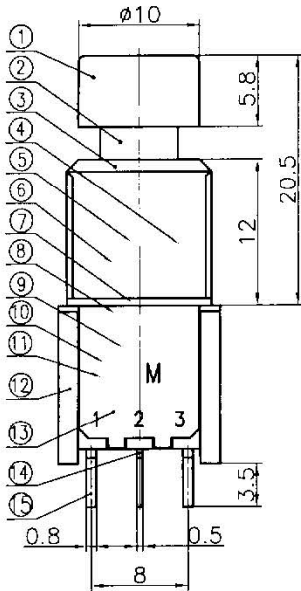

SPRINGWASHER 1 PCS

SCHMATIC

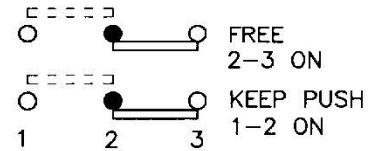

| STATUS | FREE | KEEP PULL |
|--------|------|-----------|
| ON | 2-3 | 2-1 |
| OFF | 2-1 | 2-3 |

| | | | | | |
|----|-----------|-----------------|-----|-------------|-------------------|
| 19 | WBX-450/A | Grease | A/R | | |
| 18 | W-12 | Spring Washer | 1 | SPC t=1.0 | Zinc Plating |
| 17 | W-12 | Washer | 1 | SPC t=0.4 | Zinc Plating |
| 16 | N-12 | Nut | 2 | SPC t=2 | Zinc Plating |
| 15 | PS12A105 | Terminal Lug | 4 | Brass t=0.8 | Ag Plating |
| 14 | PS12A105M | Middle Terminal | 2 | Brass t=0.5 | Ag Plating |
| 13 | PS12AM09B | Case | 1 | Spdc t=0.5 | Blue Zinc Plating |
| | PS12A11 | Basic | 1 | PBT+30%FB | NO Plating |
| 11 | PS1236 | Sliver Nail | 4 | AgNi10 | Ag Plating |
| 10 | PS12AM06 | Contact Plate | 2 | Brass | Ag Plating |
| 9 | PS12A39A | Change Stick | 2 | POM | NO Plating |
| 8 | PS12A08 | Block | 1 | POM | NO Plating |
| 7 | PS12A15A | Small Spring | 2 | Spring | NO Plating |
| 6 | PS12A15B4 | Big Spring | 1 | Spring | NO Plating |
| 5 | PS12A39 | Change Stick | 1 | Brass | Ni Plating |
| 4 | PS12A31 | Tubing | 1 | POM | No Plating |
| 3 | PS12A02D | Bushing | 1 | Zine | Ni Plating |
| 2 | PS12A01 | Shaft | 1 | Brass | Ni Plating |
| 1 | PS12A24 | Switch Top | 1 | Brass | Ni Plating |

| | | | |
|------------|-----------|------|---|
| △ | | | |
| △ | | | |
| △ | Jun.09'10 | 圖面重繪 | |
| MODEL NAME | | | B |

| TOLERANCES | | DIMENSION | SCALE | DRAWING BY | CHECKED BY | APPROVED BY | DRAWING NO. |
|-------------------|-------|-----------|-------|------------|------------|-------------|-------------|
| less than 10 | ± 0.3 | m/m | / | May.28 10 | Jun.09 10 | Jun.09 10 | PBS-24-212S |
| above 10 - 30 | ± 0.5 | | | | | | |
| above 30 - 100 | ± 1.0 | | | | | | |
| angular dimension | ± 5' | | | | | | |