

NDS series

Standard profile • dual in line switches

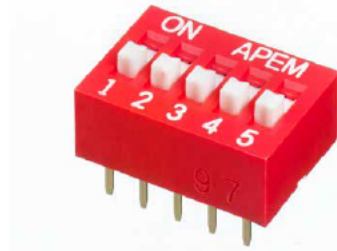

DISTINCTIVE FEATURES

1 to 12 Way

Self-cleaning wiping contacts

Gold plated terminals

Spray washable with tape seal



ENVIRONMENTAL SPECIFICATIONS

- Operating Temperature: -40 °C to +85 °C (-40 °F to +185 °F)
- Storage Temperature: -40 °C to +85 °C (-40 °F to +185 °F)
- Spray washable (with tape seal)



ELECTRICAL SPECIFICATIONS

- Max. Current/Voltage Rating:
 - Switching: 25 mA 24 VDC
 - Contact rating: 100 mA 50 VDC
- Initial Contact Resistance: 50 mΩ max
- Insulation Resistance: 100 MΩ min. at 500 VDC
- Dielectric Strength: 500 VAC min.
- Electrical Life: 2,000 cycles



MECHANICAL SPECIFICATIONS

- Operating force: 1,000 gf (9.8 N) max



MATERIALS

- Case & Actuator: PBT
- Base: PA66
- Contact: Gold plated
- Terminal: Gold plated brass
- Protection tape: Polyimide

The company reserves the right to change specifications without notice.

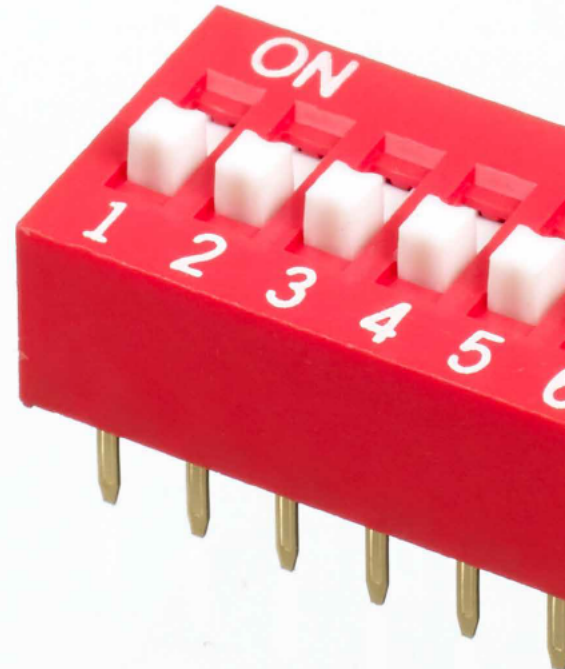

NDS series

Standard profile • dual in line switches



PACKAGING

IC TUBE THROUGH-HOLE

Number of ways	No tape seal	With tape seal
1	120 pcs	110 pcs
2	72 pcs	70 pcs
3	51 pcs	50 pcs
4	40 pcs	39 pcs
5	32 pcs	
6	27 pcs	
7	24 pcs	
8	21 pcs	
9	19 pcs	
10	17 pcs	
12	14 pcs	



CIRCUIT



2,3,4,5,6,7,8,9,10,12 way only



PCB LAYOUT

THROUGH-HOLE

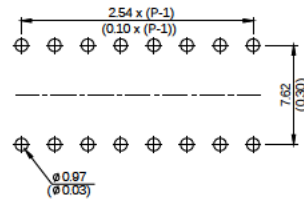

NDS series

Standard profile • dual in line switches



BUILD YOUR PART NUMBER

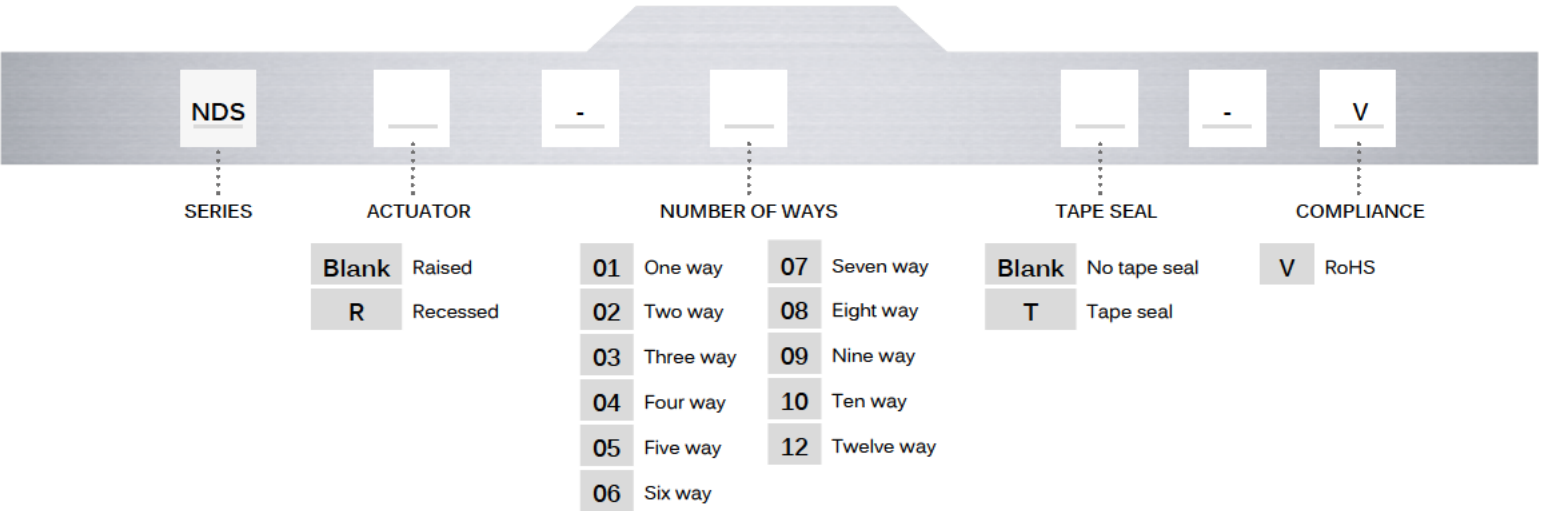

8 WAY - STANDARD PROFILE WITH RAISED ACTUATORS

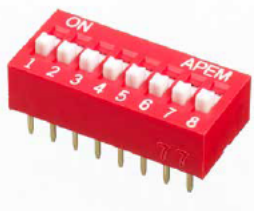

Number of ways	Dimension A	Dimension B
1	3.90 (0.15)	NA
2	6.44 (0.25)	2.54 (0.1)
3	8.98 (0.35)	5.08 (0.2)
4	11.52 (0.45)	7.62 (0.3)
5	14.06 (0.55)	10.16 (0.4)
6	16.60 (0.65)	12.70 (0.5)
7	19.14 (0.75)	15.24 (0.6)
8	21.68 (0.85)	17.78 (0.7)
9	24.22 (0.95)	20.32 (0.8)
10	26.76 (1.05)	22.86 (0.9)
12	31.84 (1.25)	27.94 (1.1)

