

Specifications

Rating:	20A 12VDC
Contact Resistance:	50mΩ Max
Insulation Resistance:	100MΩ Min
Dielectric Strength:	1500VAC 1 minute
Operating Temperature:	-25°C to +85°C
Electrical Life:	10,000+ Cycles

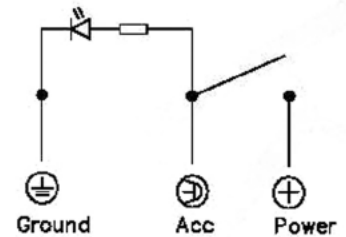
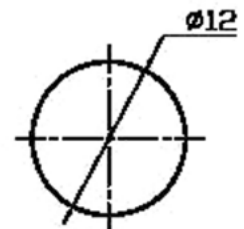
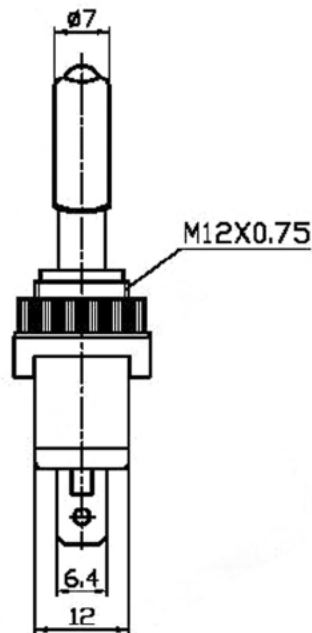
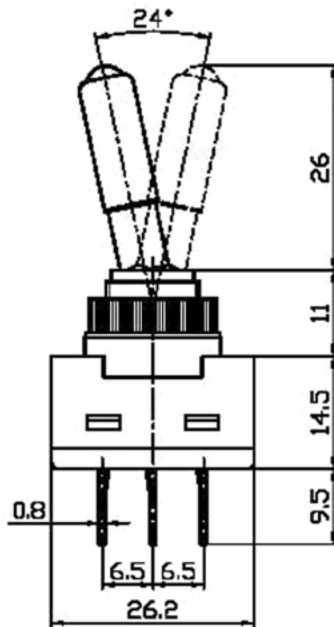

Description	Ref Code
Red LED On-Off Toggle Switch SPST 12V 20A	550105